

TWIST SHACKLE WITH NO SNAG PIN

316 STAINLESS STEEL



Import



Precision
Cast

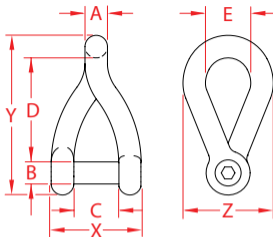
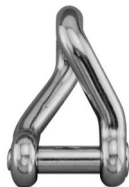

ITEM	A (size)	B	C	D	E	X (height)	Y (length)	Z (width)	WLL (lb)	WT (lb)	PACKAGING TYPE	EACH (qty)	INNER (qty)	CARTON (qty)	UPC
S0163-NS06	1/4"	0.23"	0.42"	1.00"	0.48"	1.00"	1.59"	0.95"	750	0.05	POLYBAG	1	10	300	791506062462
S0163-NS08	5/16"	0.31"	0.63"	1.30"	0.66"	1.36"	2.07"	1.26"	1,000	0.13	POLYBAG	1	10	250	791506062479
S0163-NS10	3/8"	0.38"	0.71"	1.80"	0.75"	1.64"	2.66"	1.51"	1,200	0.27	POLYBAG	1	5	125	791506062486
S0163-NS12	1/2"	0.47"	0.95"	2.20"	0.85"	2.00"	3.34"	1.87"	1,500	0.47	POLYBAG	1	1	50	791506062493

NOTE:

**NO SNAG PIN SITS FLUSH WITH BODY OF SHACKLE. SUNCOR RECOMMENDS THE USE OF A LOCKING FLUID WITH THIS TYPE OF SHACKLE.
ALL DIMENSIONS ARE NOMINAL (+/- 3%) AND ARE SUBJECT TO CHANGE WITHOUT NOTICE.**